

# GARDA

## DINING TABLES

A versatile, modular bench system designed for both interior and exterior high traffic use. The clean lines and flexibility of this collection allow you to customize to your specific design needs.



### TABLES

- Available with composite wood or sublimated wood slats.
- The frame is constructed of aluminum.
- Recyclable. 

### FINISHES

- Frame: powder coated aluminum – standard RAL colors apply.
- Slats: available in composite wood or sublimated wood – standard colors apply.
- Visit [benchmarkcontractfurniture.com](http://benchmarkcontractfurniture.com) for color charts.

### MAINTENANCE

- Metal and wood can be cleaned as needed using a soft cloth with warm water and a mild detergent. Avoid abrasive cleaners.

### NOMINAL DIMENSIONS

STYLE	MODEL	DEPTH	WIDTH	HEIGHT
 Dining Table	17150-3096-AL5	30"	96"	30"
	17150-30120-AL5	30"	120"	30"
	17150-4296-AL5	42"	96"	30"
	17150-42120-AL5	42"	120"	30"
 Levisa Dining Table	17142-3096-AL5	30"	96"	30"
	17142-30120-AL5	30"	120"	30"
	17142-4296-AL5	42"	96"	30"
	17142-42120-AL5	42"	120"	30"

### WOOD COMPOSITE OPTIONS



### SUBLIMATION OPTIONS

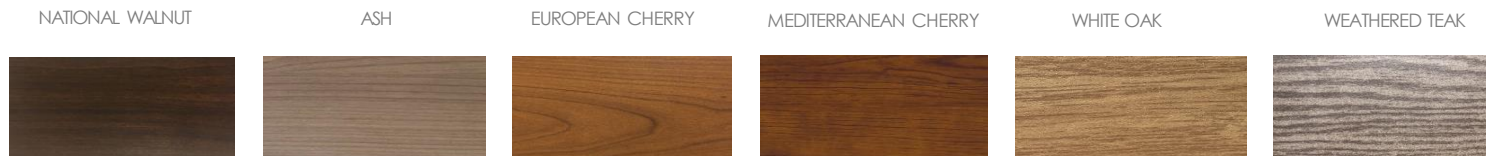

# GARDA

## BAR TABLES

A versatile, modular bench system designed for both interior and exterior high traffic use. The clean lines and flexibility of this collection allow you to customize to your specific design needs.

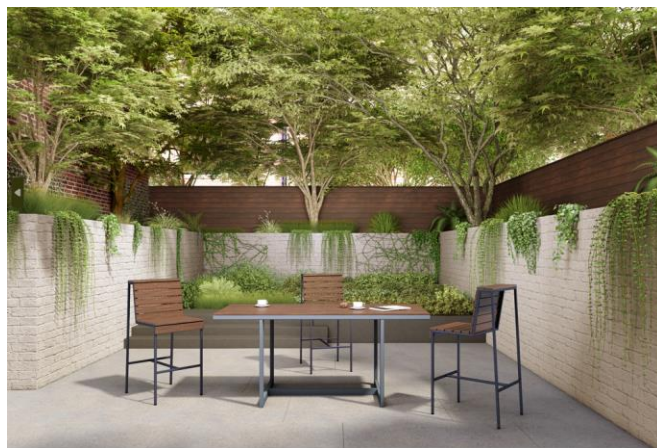

### NOMINAL DIMENSIONS

#### TABLES



- Available with composite wood or sublimated wood slats.
- The frame is constructed of aluminum.
- Recyclable. 

#### FINISHES

- Frame: powder coated aluminum – standard RAL colors apply.
- Slats: available in composite wood or sublimated wood – standard colors apply.
- Visit [benchmarkcontractfurniture.com](http://benchmarkcontractfurniture.com) for color charts.

#### MAINTENANCE

- Metal and wood can be cleaned as needed using a soft cloth with warm water and a mild detergent. Avoid abrasive cleaners.

STYLE	MODEL	DEPTH	WIDTH	HEIGHT
	17152-3096-AL5	30"	96"	42"
	17152-30120-AL5	30"	120"	42"
	17152-4296-AL5	42"	96"	42"
	17152-42120-AL5	42"	120"	42"
	17144-3096-AL5	30"	96"	42"
	17144-30120-AL5	30"	120"	42"
	17144-4296-AL5	42"	96"	42"
	17144-42120-AL5	42"	120"	42"

#### WOOD COMPOSITE OPTIONS



#### SUBLIMATION OPTIONS

